

SKIDDING WINCH

NORSE 3500



- Safety grill
- Segmented butt plate
- Cable guard
- Large cable capacity
- Good parallel lifting

Safety grill protects driver, and is handy for hanging tools on

Segmented butt plate facilitates skidding, and performs well at the staging area. (Pat. pend.)



Cable guard prevents injury.

Low drag point prevents rearing.

Good attachment provides better parallel lifting.

The NORSE 3500 is mounted on the tractor's three-point hitch. NORSE 3500 is a product of many years' experience. This model is developed in close cooperation with users, and satisfies all safety requirements.

NORSE 3500 has a ratchet brake and cord operation, and the segmented butt plate facilitates skidding and staging operations. See NORSE 3500 at your dealer. Other models include: NORSE 2500, NORSE 4500, NORSE 5500 and NORSE DUPLEX.

Cable

CAPACITY:

Dia.	Effective Breakage Load	Max. Length	Weight
8mm (5/16")	4200 kgf. (9,260 lbs)	100 m (325 ft)	27 kg (59.5 lbs)
9 mm (11/32")	5317 kgf. (11,720 lbs)	75 m (245 ft)	26 kg (57 lbs)
10 mm (3/8")	6570 kgf. (14,480 lbs)	60 m (195 ft)	25 kg (55 lbs)

Recommended cable diameter 10 mm (3/8"). The structure of steel cable normally supplied is 6 x 26 WS + IWRC.

DEALER:

Technical Specifications

Pulling capacity inner layer	3500 kgf (7,715 lbs)
Pulling capacity outer layer	1475 kgf (3,250 lbs)
Required tractor output	27 kW/37hp
Max. torque input to winch	48 kpm
*Average cable speed	1.30 m/s (4.2 ft/sec.)
*Min. cable speed	0.75 m/s (2.4 ft/sec.)
*Max. cable speed	1.80 m/s (5.9 ft/sec.)
Recommended p.t.o. shaft	W2200/A3
Weight, compl. winch minus cable	235 kg (518 lbs)
Maximum width	1400 mm (4 ft 7 in.)
Max. height with grill and butt plate	1700 mm (5 ft 7 in.)

*At max. permissible input shaft speed of 540 rpm.

IMPORTER/DISTRIBUTOR:

LABONVILLE
INCORPORATED
R.F.D. #1 BERLIN, N.H. 03570

MANUFACTURER:

ES Elkem as
Formek

P.O. Box 133
3160 STOKKE - NORWAY
Tel.: +47 33 36 320
Telex: 70 648 norske n

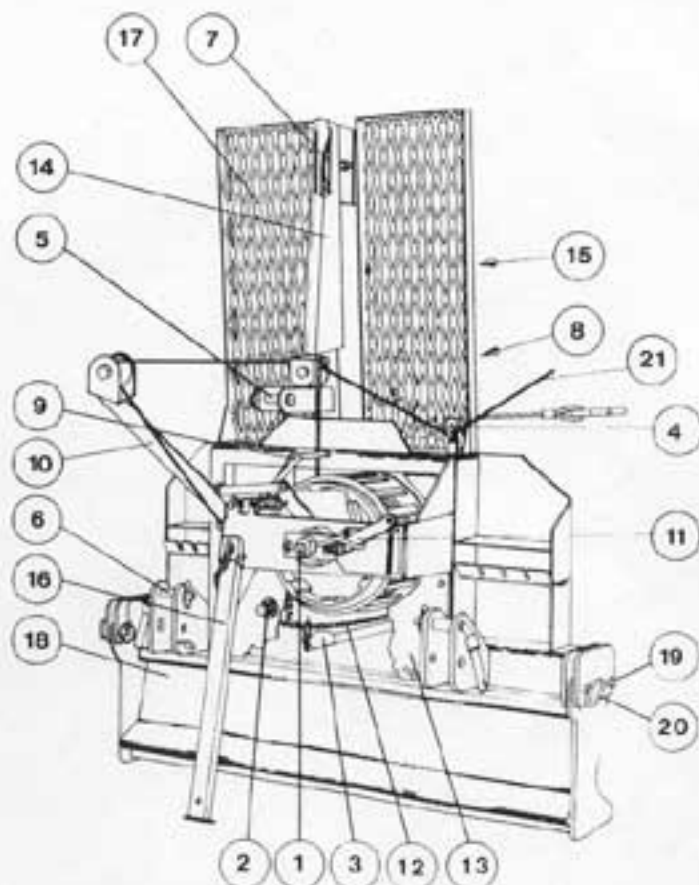

Pos.	Part No.	Number	Description
1	-	1	DRIVE UNIT
2	3322	1	Input drive shaft and chain wheel cpl. w/housing
3	2107	1	Chain tightener
3-1	1001	1	Spring
4	1027	1	Pulley
5	1279	1	Link pin $\varnothing 25$ mm w/linch pin-top stay
5	1313	1	Link pin $\varnothing 19$ mm w/linch pin-top stay
5-1	1517	1	Linch pin $7/16$ "
6	1053	2	Lower link pin w/linch pin
6-1	1517	2	Linch pin $7/16$ "
7	-	1	Block wheel
8	1186	1	Center block, cpl.
9	-	1	Wire rope brake
10	-	1	Lever
11	1351	1	Ratchet brake cpl.
12	3334	1	Chain $3/4$ " simplex 73 links + lock
12-1	1126	1	$3/4$ " simplex chain joining link
13	1338	1	Lower cover w/screws
14	1339	1	Upper cover w/screws, rear
15	1340	1	Upper cover w/screws, front
16	1344	1	Parking leg cpl.
17	1341	1	Protection grille w/screws
18	2180	1	Logging pan
19	1342	2	Bolt w/split pin
20	1343	2	Locking bolt w/linch pin
20-1	1517	2	Linch pin $7/16$ "
21	1288	1	Clutch cord

Formek a/s

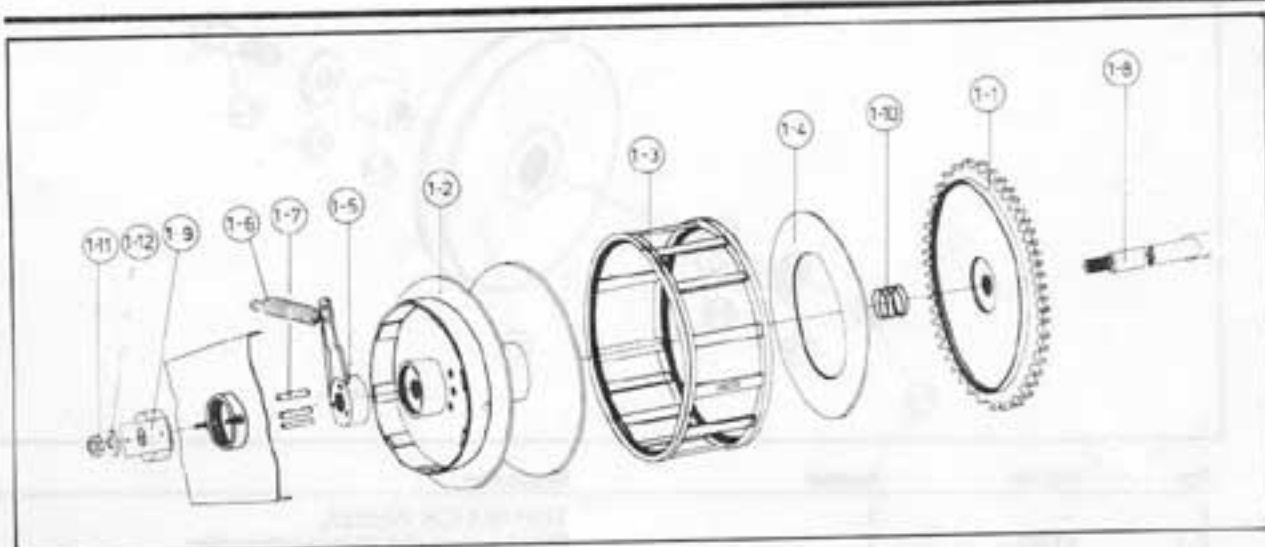

Pos.	Part No.	Number	Description
1	—	1	DRIVE UNIT
1- 1	1119	1	Chain wheel w/bearing
1- 1A	1514	2	Ball bearing 6307 2RS
1- 2	2078	1	Wire drum w/bearing
1- 2A	1514	3	Ball bearing 6307 2RS
1- 3	1345	1	Wire guard w/screws
1- 4	1518	1	Clutch lining
1- 5	2136	1	Clutch arm
1- 6	1522	1	Spring
1- 7	1018	3	Clutch pins
1- 8	2097	1	Main shaft $\varnothing 35$ mm
1- 9	1383	1	Clutch half w/screws (main shaft support)
1-10	1533	1	Spring
1-11	1538	1	Nut M30 x 2
1-12	1537	1	Washer

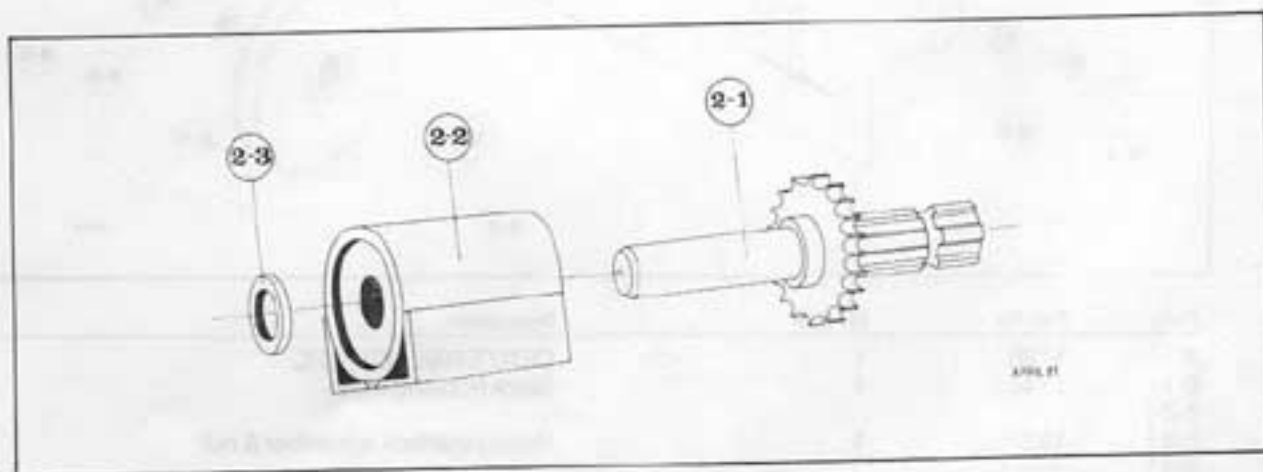

Pos.	Part No.	Number	Description
2	3322	1	INPUT DRIVE SHAFT CPL. W/HOUSING
2-1	3303	1	Sprocket w/shaft
2-2	3204	1	Housing w/bearing
2-2A	1501	2	Ball bearing 6306 2RS
3-3	1052	1	Stop washer (to be welded on)

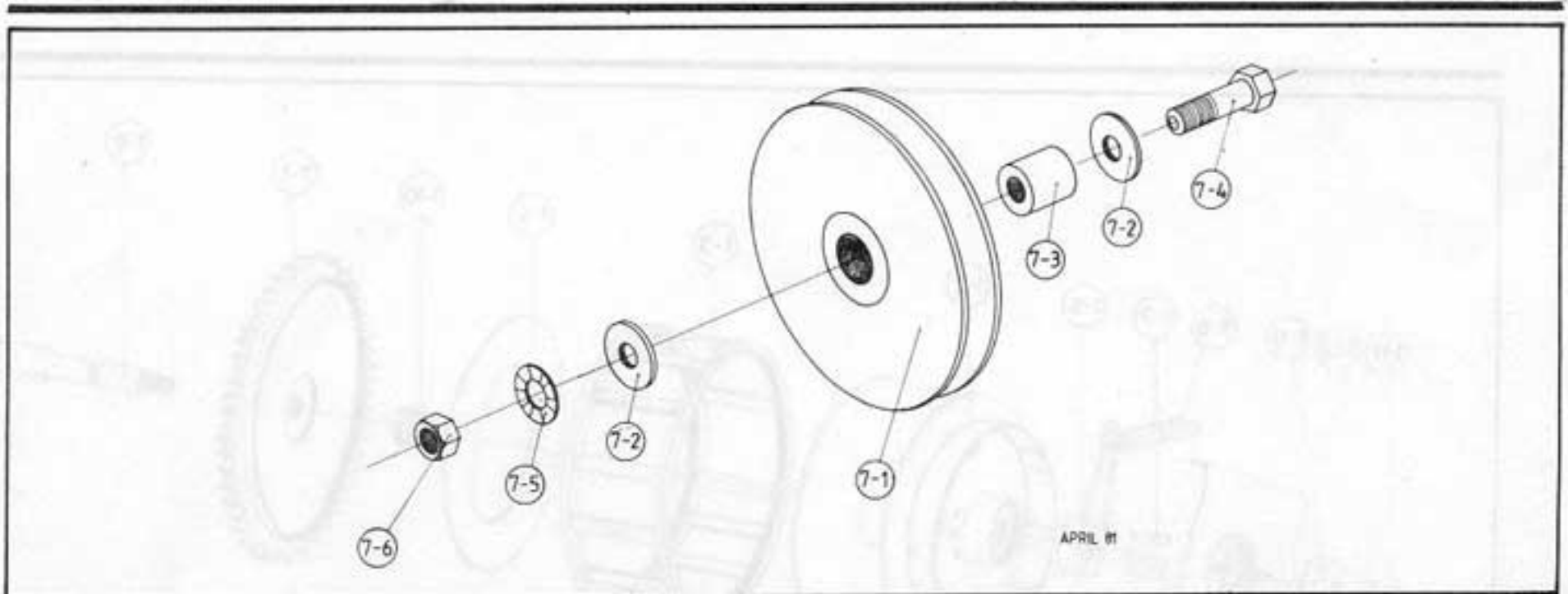

Pos.	Part No.	Number	Description
7	-	1	TOP BLOCK WHEEL
7-1	1122	1	Block wheel \varnothing 170 mm w/bearing
7-1A	1514	1	Ball bearing 6307 2RS
7-2	1091	2	Spacing washer
7-3	1090	1	Bushing
7-4 } 7-5 } 7-6 }	1527	1	Hexagonal bolt w/washer & nut

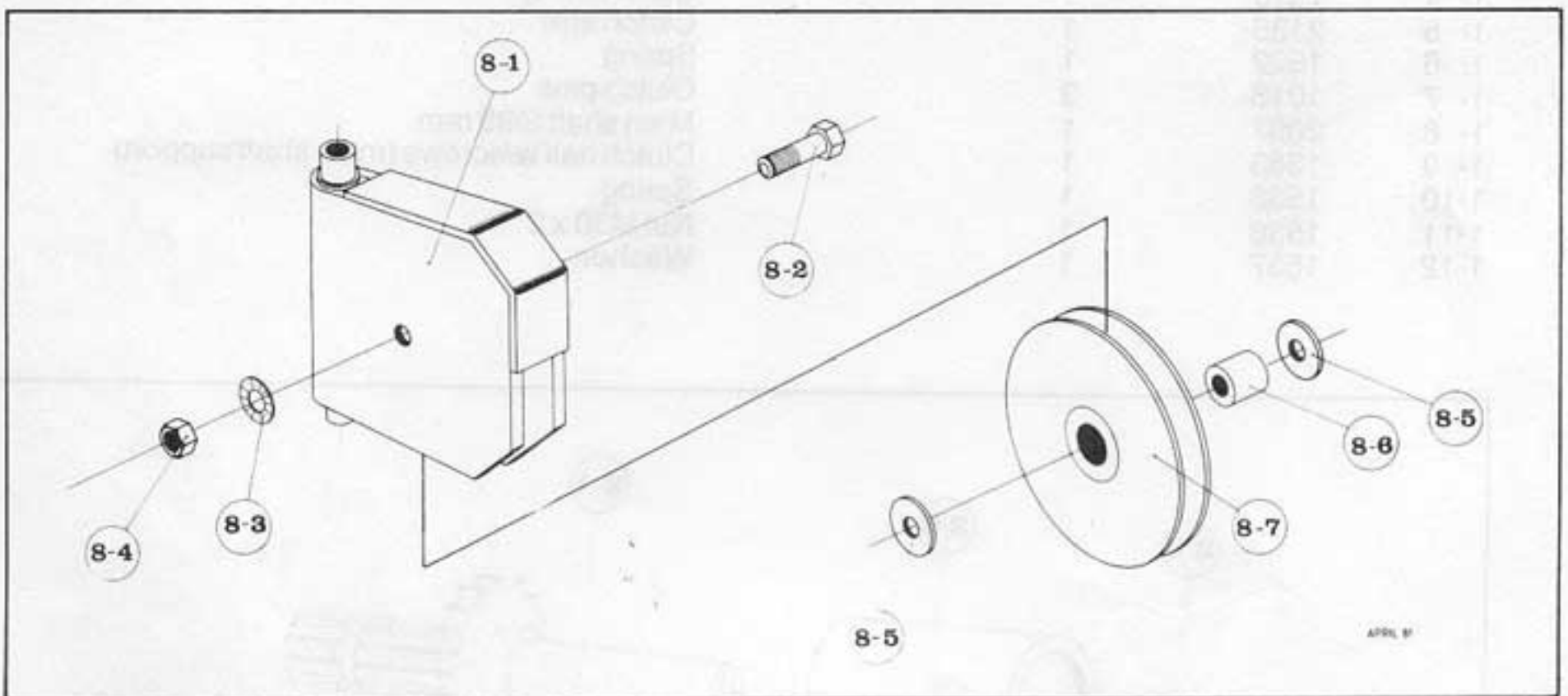

Pos.	Part No.	Number	Description
8	1186	1	CENTER BLOCK CPL.
8-1	1146	1	Block housing w/pin
8-2 } 8-3 } 8-4 }	1527	1	Hexagonal bolt w/washer & nut
8-5	1091	2	Spacing washer
8-6	1090	1	Bushing
8-7	1122	1	Block wheel \varnothing 170 mm w/bearing
8-7A	1514	1	Ball bearing 6307 2RS

Formek a/s

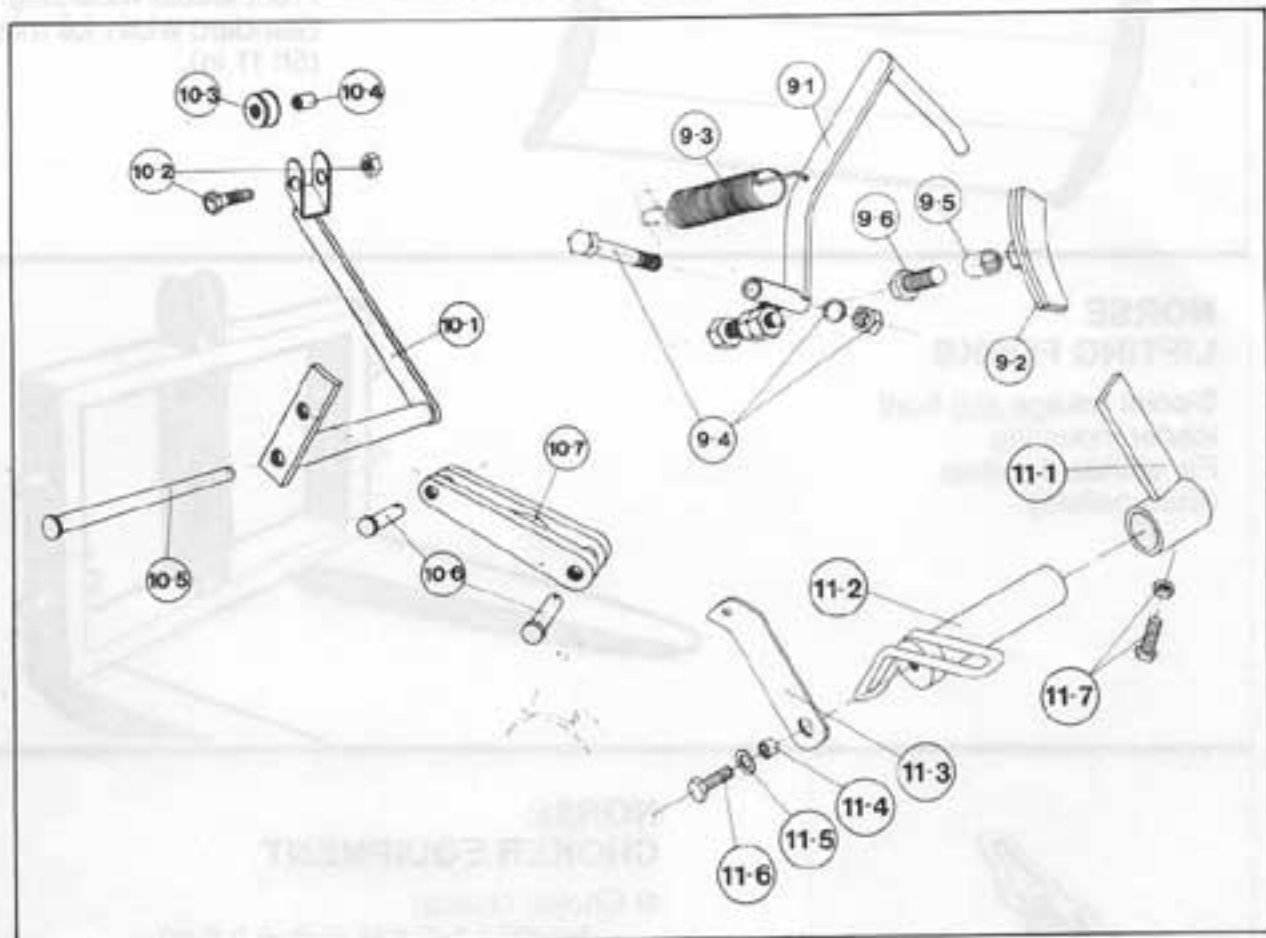

Pos.	PartNo.	Number	Description
9	-	1	WIRE ROPE BRAKE
9-1	1347	1	Brake arm w/bolt and nut
9-1A	1348	1	Hexagonal bolt M 12 x 30 w/nut
9-2	1349	1	Brake lining w/rivets and bolt
9-3	1001	1	Spring
9-4	1350	1	Hexagonal bolt M 12 x 100 w/washer & nut
9-5	1395	1	Bushing
9-6	1199	1	Hexagonal bolt M 12 x 30
10	-	1	LEVER
10-1	1378	1	Lever w/bushing
10-2	1379	1	Hexagonal bolt M 8 x 35 w/nut
10-3	1380	1	Pulley
10-4	1381	1	Distance bushing
10-5	1382	1	Shaft w/split pin
10-6	1024	2	Clevis pin w/split pin
10-7	1022	1	Connection
11	1351	1	RATCHET BRAKE CPL.
11-1	2130	1	Ratchet brake
11-2	2127	1	Ratchet pin
11-3	2135	1	Brake lever
11-4	1352	1	Bushing
11-5	2134	1	Washer
11-6	2119	1	Bolt M 12 x 25
11-7	1353	1	Hexagonal bolt M 10 x 35 w/nut

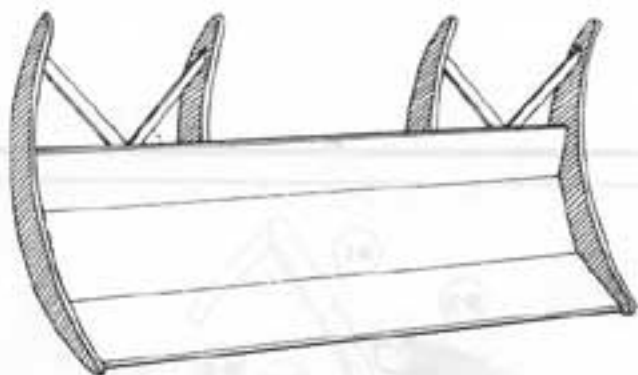

NORSE DOZER BLADE

Front loader mounting.
Standard width 1,8 mts
(5ft 11 in).

NORSE LIFTING FORKS

3-point linkage and front
loader mounting.
For standard pallets
(Euro-pallets).

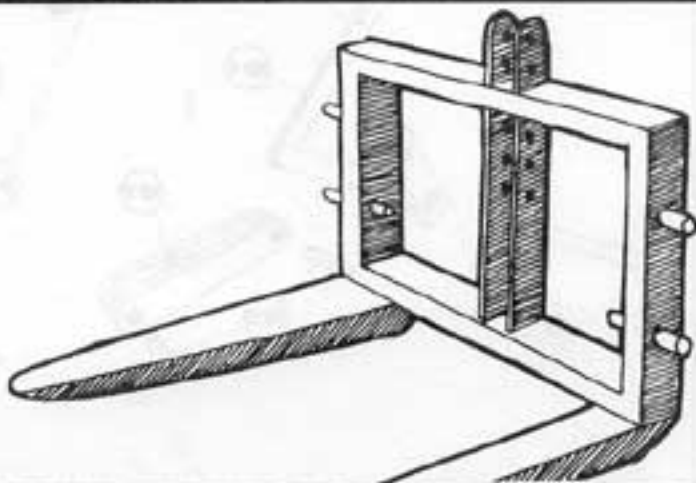

NORSE CHOKER EQUIPMENT

- * Choker chains:
 - length 1,5-2 mts (5 ft-6 ft 6 in)
 - breaking load 4.000 - 7.000 kgs
(8.800-15.400 lbs)
- * Cable sliders
- * Chokers
- * Cable end hooks
- * Blocks (also self releasing)

ASK YOUR DEALER!

