

SKIDDING WINCH **NORSE** 4500/5500



- Safety grill
- Segmented butt plate
- Winding unit

- Good parallel lifting
- Large cable capacity
- Cable guard

Winding unit prevents jamming of the cable on the drum, extending the life of the cable. (Pat. pend.)

Safety grill protects driver, and is handy for hanging tools on.

Segmented butt plate facilitates skidding, and performs well at the staging area. (Pat. pend.)



Cable guard prevents injury.

Low drag point prevents rearing.

Good attachment provides better parallel lifting.

The NORSE 4500 and 5500 are mounted on the tractor's three-point hitch. NORSE 4500 and 5500 are products of many years' experience. These models are based on new principles developed in close cooperation with users, and satisfy all safety requirements. NORSE 4500 and 5500 have a cable winding system which prevents cable jamming on the drum.

Both models have the same design, but the 5500 winch is a geared-down version with greater pulling power. The segmented butt plate facilitates skidding and staging operations. Both have ratchet brakes and cord operation. See and try NORSE winches at your dealer.

Other models include: NORSE 2500, NORSE 3500 and NORSE DUPLEX.

Cable

CAPACITY:

Dia.	Effective Breakage Load	Max. Length	Weight
8mm (5/16")	4200 kgf (9,260 lbs)	140m (460 ft)	38 kg (84 lbs)
9mm (11/32")	5317 kgf (11,720 lbs)	110m (360 ft)	39 kg (86 lbs)
10mm (3/8")	6570 kgf (14,480 lbs)	90m (295 ft)	38 kg (84 lbs)
11mm (7/16")	7940 kgf (17,500 lbs)	70m (230 ft)	37 kg (81 lbs)
12mm (1/2")	9460 kgf (20,830 lbs)	55m (180 ft)	34 kg (75 lbs)

The structure of the steel cable normally supplied is 6 x 26WS + IWRC

Technical Specifications

	NORSE 4500	NORSE 5500
Pulling capacity inner layer	4500 kg (9,920 lbs)	5500 kgf (12,125 lbs)
Pulling capacity outer layer	2165 kgf (4,775 lbs)	2670 kgf (6,325 lbs)
Required tractor output	41 kW/55 hp	27 kW/37 hp
Max. torque input on winch	73 kNm	49 kNm
*Average cable speed	1.40 m/s (4.6 ft/sec)	0.75 m/s (2.5 ft/sec)
*Min. cable speed	0.90 m/s (3 ft/sec)	0.50 m/s (1.6 ft/sec)
*Max. cable speed	1.90 m/s (6.2 ft/sec)	1.00 m/s (3.3 ft/sec)
Recommended cable diameter	□ 11 mm (7/16")	□ 12 mm (1/2")
Recommended p. l.e. shaft	W2400/A4	W2400/A4
Weight, complete winch minus cable	355 kg (783 lbs)	365 kg (805 lbs)
Maximum width	1530 mm (5 ft 2 in)	1530 mm (5 ft 2 in)
Maximum height w/grill and butt plate	2000 mm (6 ft 7 in)	2000 mm (6 ft 7 in)

*At max. permissible input shaft speed of 540 rpm.

DEALER:

LABONVILLE
INCORPORATED
R.F.D. #1 BERLIN, N.H. 03570

MANUFACTURER:



Elkem as
Formek

PO Box 133
3160 STOKKE - NORWAY
Tel. 47 (33) 36 320
Telex: 21 648 norske n

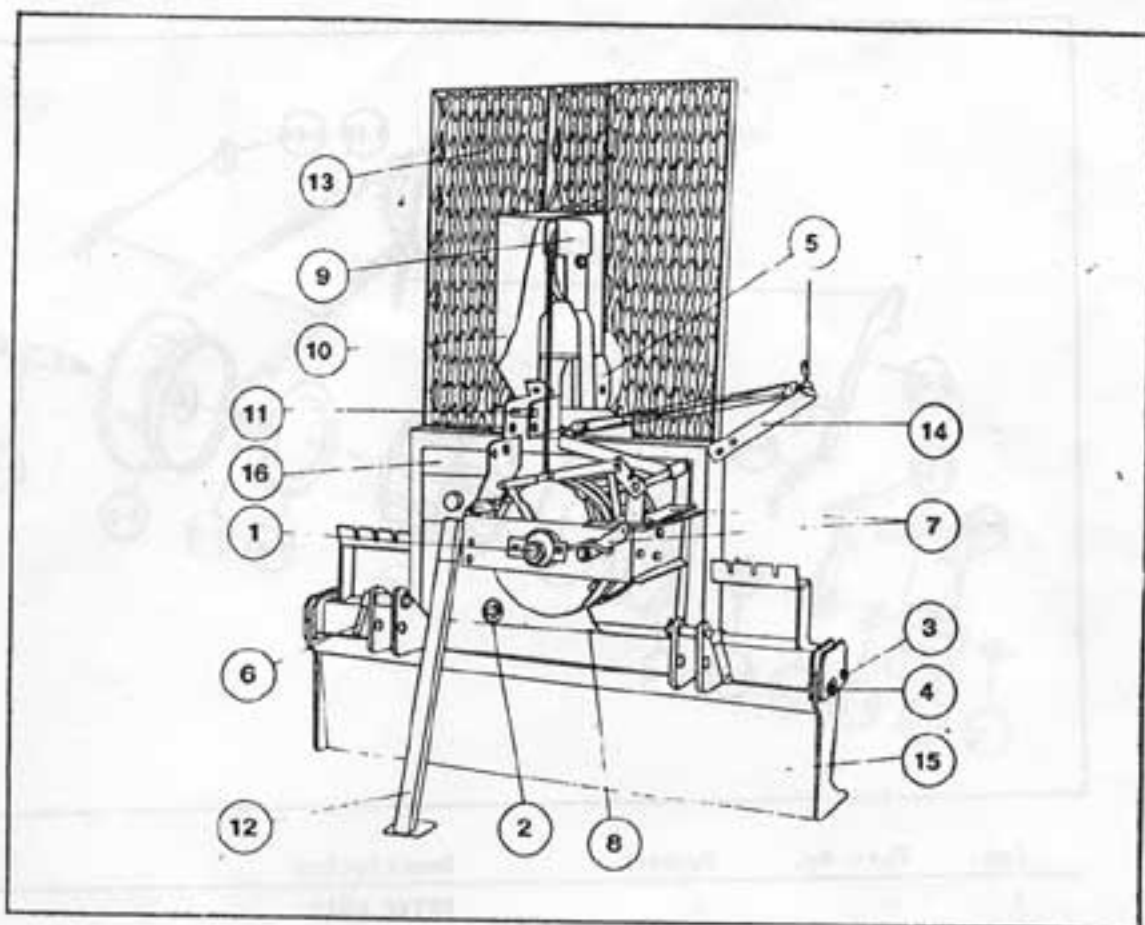

Pos.	Part No.	Number	Description
1	-	1	DRIVE UNIT
2	3322	1	Input drive shaft and chain wheel cpl. w/housing
3	1342	2	Bolt w/split pin
4	1343	2	Locking bolt w/linch pin
4-1	1517	2	Linch pin 7/16"
5	1186	1	Center block, cpl.
6	1053	2	Link pin w/linch pin
6-1	1517	2	Linch pin 7/16"
7	-	1	Ratchet brake/wire rope brake/clutch lever
8	1276	1	Lower cover w/screws
9	-	1	Wire rope winding unit
10	1278	1	Cover w/screws, wire rope winding unit
11	1279	1	Link pin w/linch pin Ø25, top stay
11	1313	1	Link pin w/linch pin Ø19, top stay
11-1	1517	1	Linch pin 7/16"
12	1280	1	Parking leg
13	1281	1	Protection grille w/screws
14	1287	1	Bracket w/screws, for pulley
14-1	1027	2	Pulley
15	1358	1	Logging pan
16	1277	1	Cover w/screws

Formek a/s

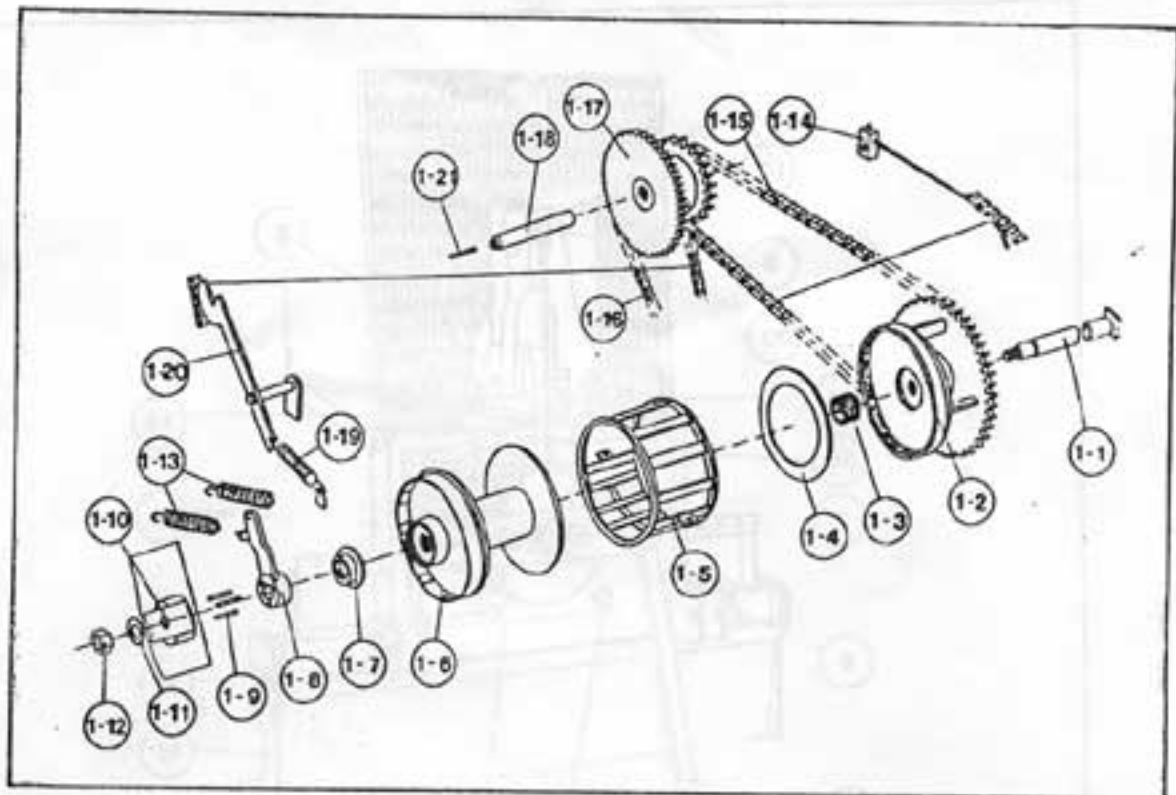

Pos.	Part No.	Number	Description
1	-	1	DRIVE UNIT
1-1	1227	1	Main shaft
1-2	1256	1	Chain wheel w/bearing
1-2A	1129	2	Ball bearing 6310 2RS
1-3	1220	1	Spring
1-4	1218	1	Clutch lining
1-5	1258	1	Wire guard w/screws
1-6	1363	1	Wire drum w/bearing
1-6A	1129	2	Ball bearing 6310 2RS
1-7	1259	1	Washer
1-8	1260	1	Clutch arm
1-9	1018	3	Clutch pins
1-10	1275	1	Clutch half w/screws
1-11	1537	1	Washer
1-12	1538	1	Nut M30x2
1-13	1522	2	Spring
1-14	1261	1	Chain tightener cpl.
1-15	1262	1	Chain 1" simplex 59 links + lock
1-15A	1127	1	1" simplex chain joining link
1-16	1263	1	Chain 3/4" simplex 59 links + lock
1-16A	1126	1	3/4" simplex chain joining link
1-17	1264	1	Chain wheel w/ball bearing
1-17A	1514	2	Ball bearing 6307 2RS
1-18	1265	1	Intermediate shaft
1-19	1001	1	Spring
1-20	1266	1	Chain tightener cpl.
1-21	1269	1	Clamping case

Formek a/s

Formek a/s

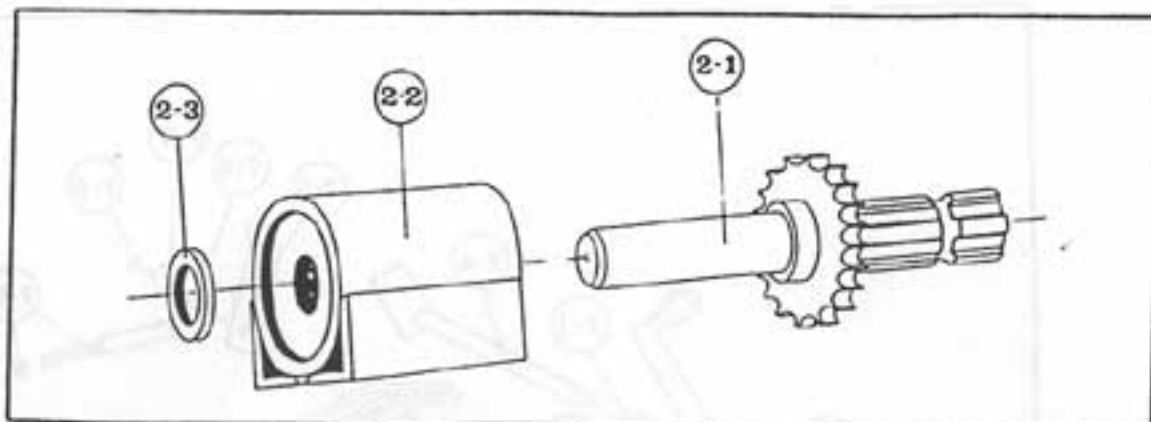

Pos.	Part No.	Number	Description
2	3322	1	INPUT DRIVE SHAFT CPL. W/HOUSING
2-1	3303	1	Sprocket w/shaft
2-2	3204	1	Housing w/bearing
2-2A	1501	2	Ball bearing 6306 2RS
2-3	1052	1	Stop washer (to be welded on)

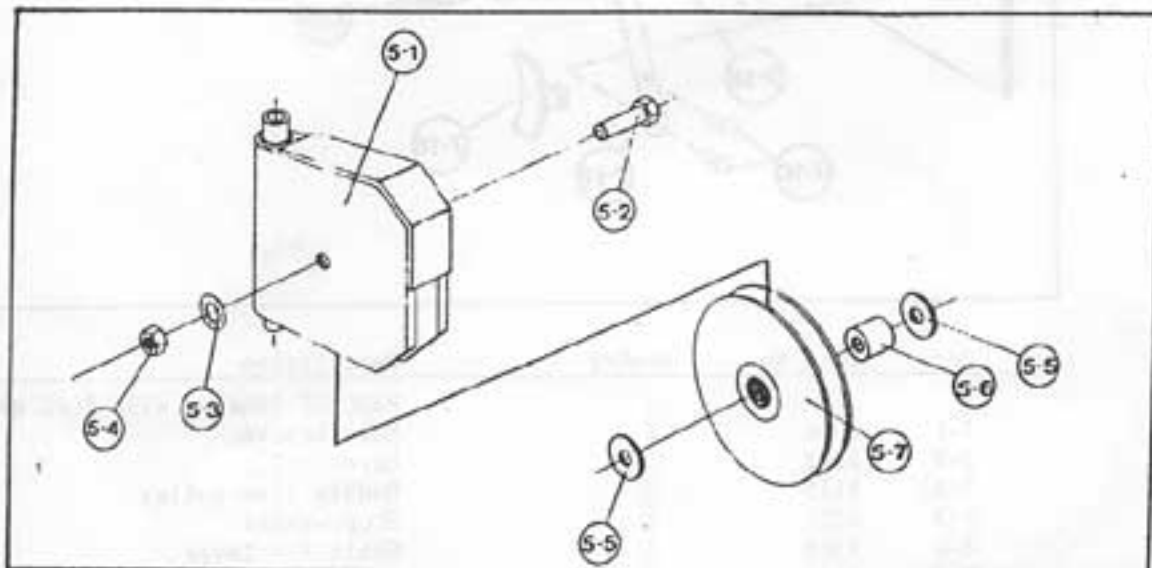

Pos.	Part No.	Number	Description
5	1186	1	CENTER BLOCK CPL.
5-1	1146	1	Block housing w/pin
5-2			
5-3	1527	1	Hexagonal bolt w/washer and nut
5-4			
5-5	1091	2	Spacing washer
5-6	1090	1	Bushing
5-7	1122	1	Block wheel Ø170 w/bearing
5-7A	1514	1	Ball bearing 6307 2RS

Formek a/s

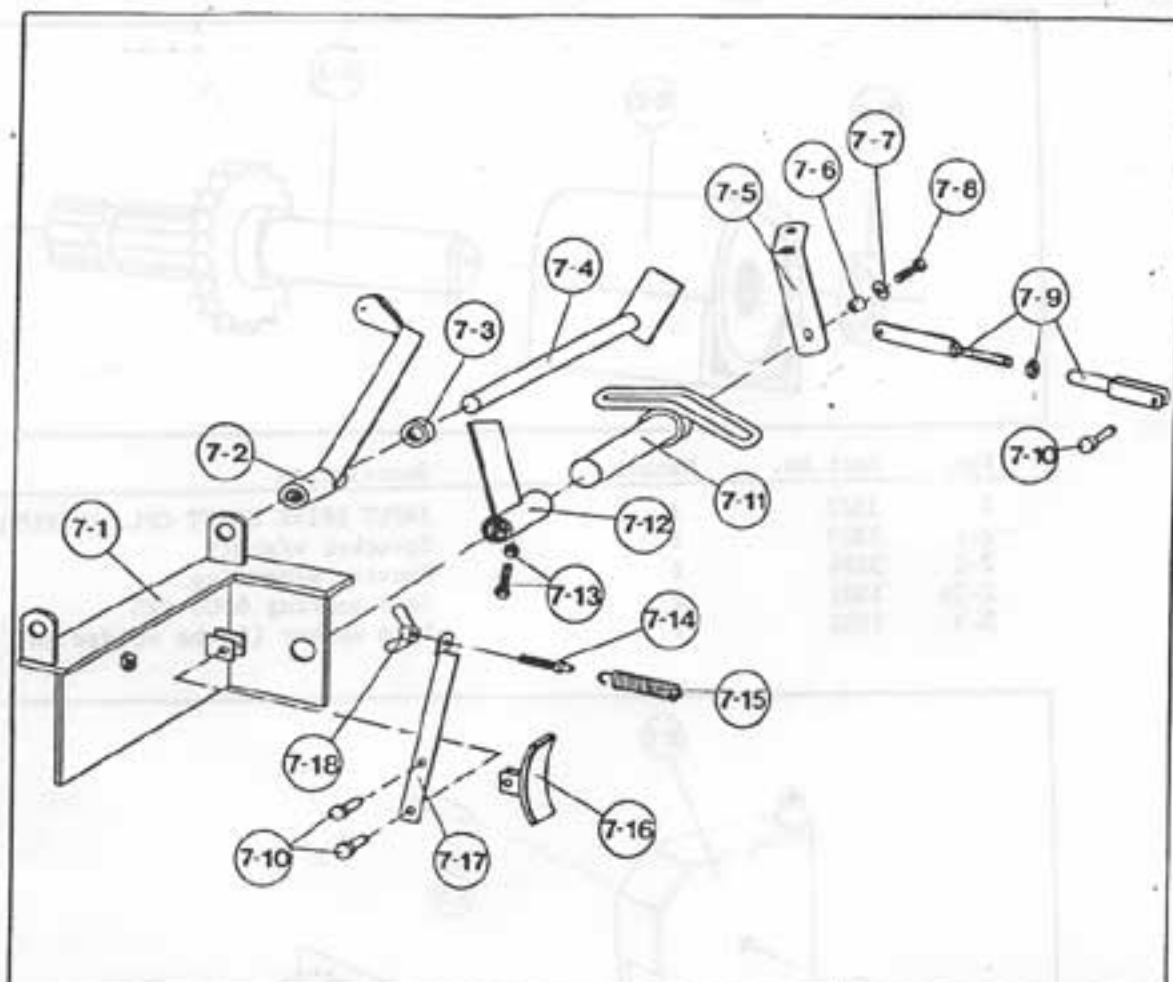

Pos.	Part No.	Number	Description
7	-	1	RATCHET BRAKE / WIRE ROPE BRAKE / CLUTCH LEVER
7-1	1366	1	Main bracket
7-2	1367	1	Lever cpl.
7-2A	1115	1	Double line pulley
7-3	1254	1	Stop washer
7-4	1368	1	Shaft for lever
7-5	2135	1	Brake lever
7-6	1352	1	Bushing
7-7	2134	1	Washer
7-8	2119	1	Nut M12x25
7-9	1252	1	Connection
7-10	1024	3	Clevis pin w/split pin
7-11	1369	1	Ratchet pin
7-12	2130	1	Ratchet brake
7-13	1353	1	Hexagonal bolt M10x35 w/nut
7-14	1372	1	Adjustment screw
7-15	1001	1	Spring
7-16	1370	1	Brake lining w/rivets and bolt
7-17	1371	1	Brake arm w/bolt and nut
7-18	1295	1	Nut

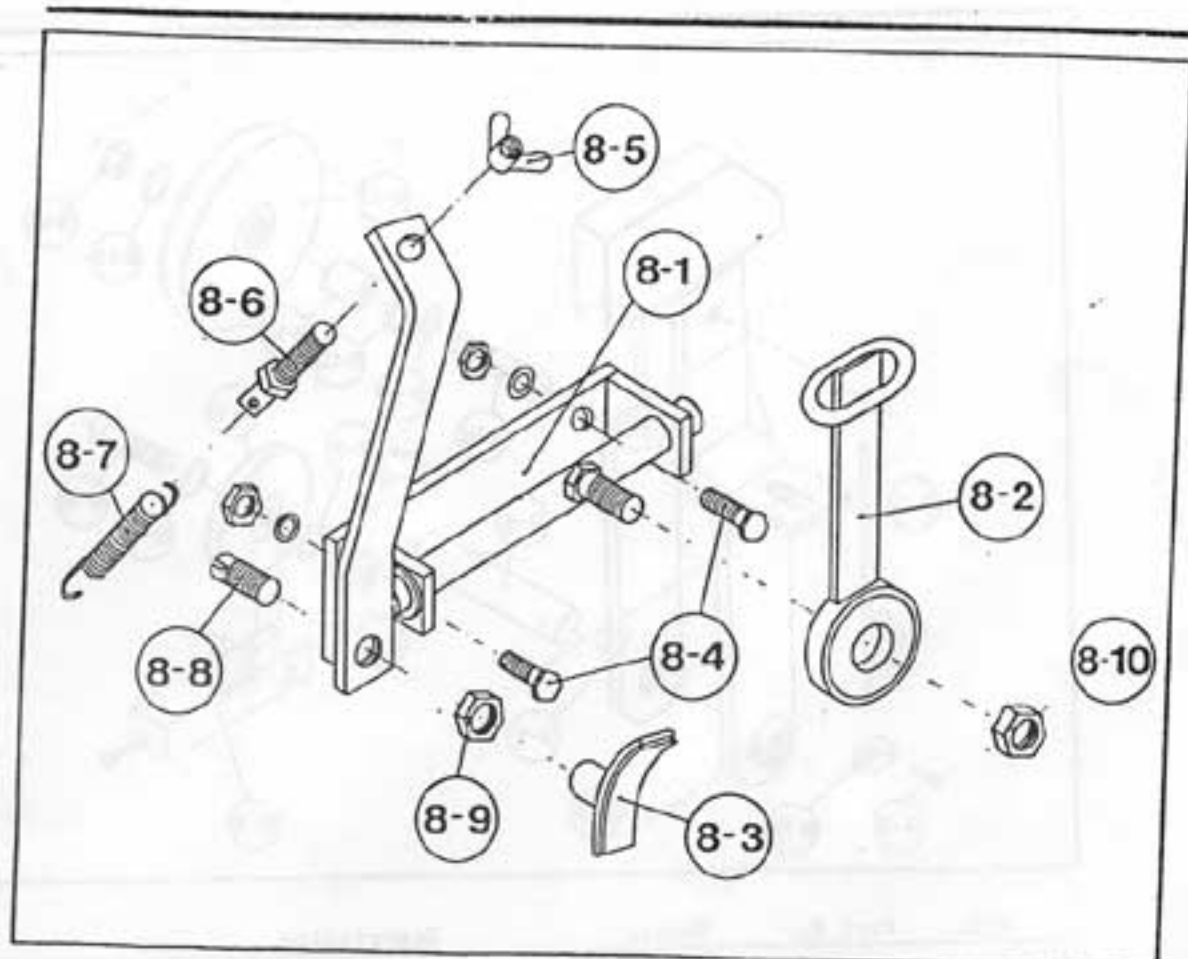

Pos.	Part No.	Number	Description
8	-	1	FRICITION BRAKE
8-1	1385	1	Brake bracket
8-2	1386	1	Brake arm w/bearing
8-2A	1503	1	Ball bearing 6303 ZFS
8-3	1387	1	Brake w/lining
8-4	1304	2	Hexagonal bolt M10x25 w/washer and nut
8-5	1295	1	Nut
8-6	1020	1	Adjustment screw
8-7	1001	1	Spring
8-8	1388	1	Adjustment screw
8-9	2072	1	Nut M10
8-10	1389	1	Nut M6

Formek a/s

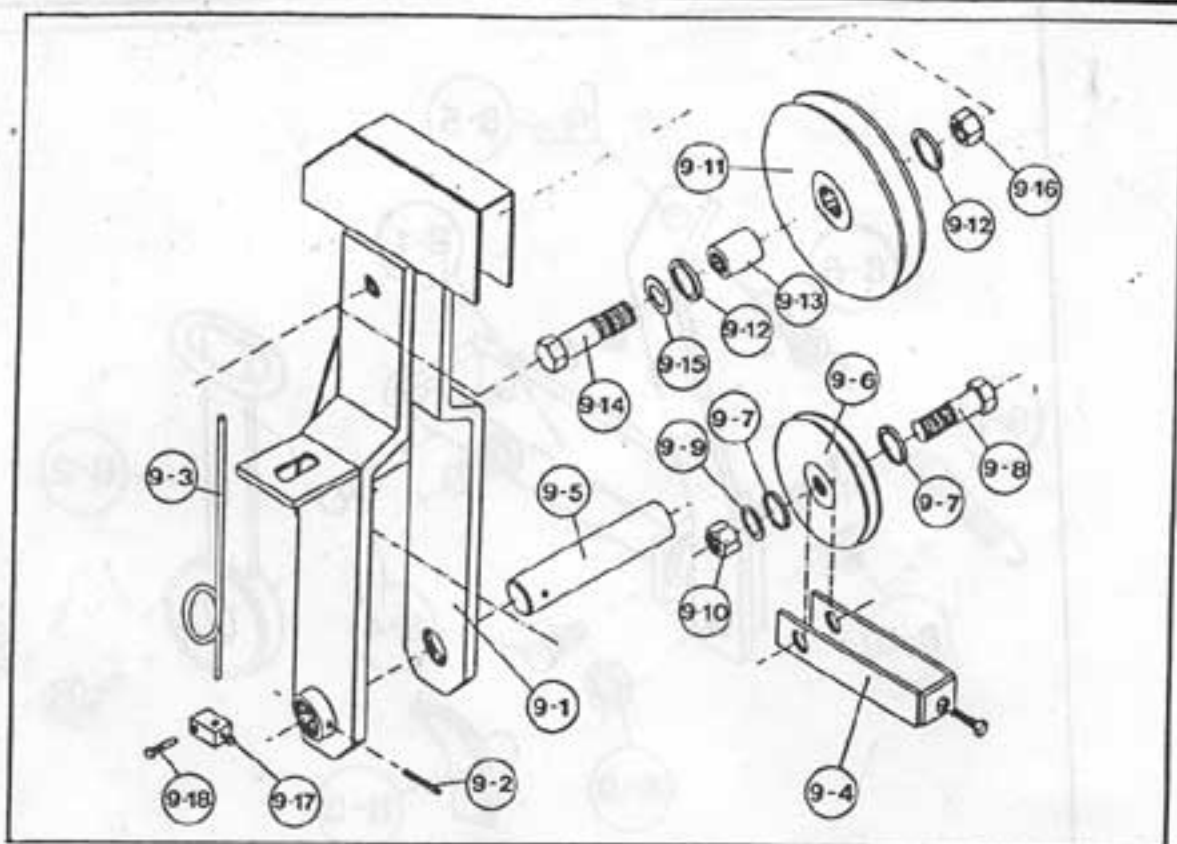

Pos.	Part No.	Number	Description
9	1267	1	WIRE ROPE WINDING UNIT W/BLOCK WHEEL
9-1	1268	1	Winding bracket w/o block wheel
9-2	1269	1	Clamping case
9-3	1360	1	Spring
9-4	1270	1	Adjustment bracket w/screw
9-4A	1271	1	Hexagonal bolt
9-5	1272	1	Shaft
9-6	1029	1	Block wheel Ø125 w/ball bearing
9-6A	1506	1	Ball bearing 6304 2RS
9-7	1075	2	Washer
9-9	1527	1	Hexagonal bolt w/washer and nut
9-10			
9-11	1145	1	Block wheel Ø200 w/ball bearing
9-11A	1514	1	Ball bearing 6307 2RS
9-12	1091	2	Washer
9-13	1090	1	Bushing
9-14			
9-15	1274	1	Hexagonal bolt w/washer and nut
9-16			
9-17	1365	1	Lock for spring, w/screw
9-18	1364	1	Hexagonal bolt M12x30 w/washer